

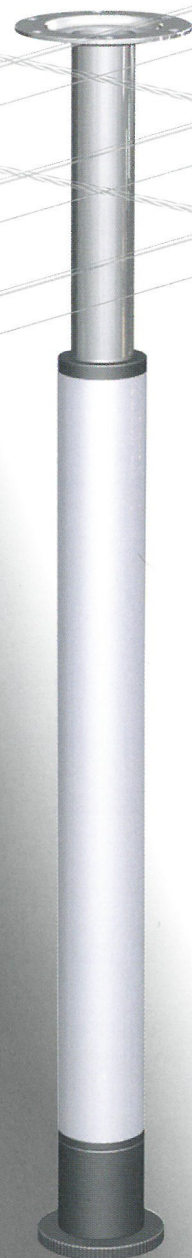

Heart & Technology



LEGMAN

KOYO ENGINEERING CO.,LTD.



U.S. Patent No. US6,299,113B1
EU Patent No. EP101395 B1
CHINA Patent No. ZL9912775.9
MADE IN JAPAN



ISO 9001 Certified

The KOYO LEGMAN™ System

is a revolutionary modular solution to the requirements for flexibility in our work environments. The System has many applications such as store fixtures, office/contract, nursing home, training rooms, laboratories, libraries, hotels, geriatric and residential furniture.

The System offers:

- An Economic, Ergonomic, Mechanical Alternative to electrical or Pneumatic systems.
- Fast, Safe and Easy operation.
- Excellent Adjustment range.
- Mobile or Stationary Solutions via Choice of Casters or Levelers.

Quick, Smooth and Safe Adjustment. No tools required.

Original Patented "STEP" Lock Mechanism.

U.S. Patent No. US 6,299,113B1 EU Patent No. EP101395 B1, China Patent No. ZL99127775.9

How to adjust upward.

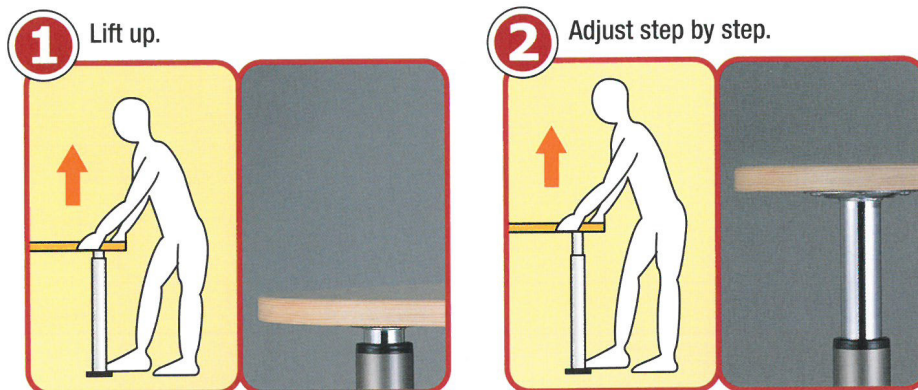

Mode of Operation :

The LEGMAN operates on a step-by-step ratchet system. Each position is 3/4 inch (20 mm) apart, and the legs have 4,8 and 12 inch (100 mm, 200 mm and 300 mm) adjustment ranges.

How to adjust downward...with slowdown effect.



Notes:

- * Used where adjustability is only needed periodically, for instance when new employee occupies a desk.
- * Remove objects from table top before adjusting table height to prevent objects from falling.
- * Regularly tighten screws under table top when tables frequently moved to prevent screws from working loose.
- * Occasionally, a drop of oil can be applied on inner tube to make up/down movement smoother.

Load Capacity Exceeding all International Table Test Standards. Meets or exceeds ANSI / BIFMA requirements.

Load Test : 1,980 Lbs. per leg (vertical load) .

Cycle Tested to 20,000 repetitions. (For KV, KVI & KVT)

Note : KVS (ϕ 43mm version) has about 450kg (990lbs) capability per a leg.

Durable and Stylish Accessories.

Interchangeable accessories are available to further enhance the mobility, stability and flexibility of the system.



Winner of the Interzum Award Intelligent Material & Design 2001

At the worlds largest fair of furniture components, interzum Cologne in Germany, KOYO LEGMAN was selected among 1793 participants from 60 countries as one of the highest quality products of intelligent design.



LEGMAN KV SERIES

Dimensional data not binding. We reserve the right to alter specifications without prior notice.

MULTIPLE LEG APPLICATION



Product Name STATIC LEG	Adjustable range(mm)	Steps	Per Step (mm)	Height range (mm) Min-Max
KV 705	0	0	0	705
Product Name ADJUSTABLE LEG	Adjustable range(mm)	Steps	Per Step (mm)	Height range (mm) Min-Max
KV 705-1	100	5	20	705-805
KV 705-2	200	10	20	705-905
KV 705-3	200	5	40	705-905
KV 705-4	300	15	20	705-1005

Diameter of leg available : 60.5 mm

Note : Casters / Glides not included (order separately)

Formula of Product Code

KV 705- 1

Minimum Height (Included Caster / Glide) | Type of Adjustable range/step (See Backside)

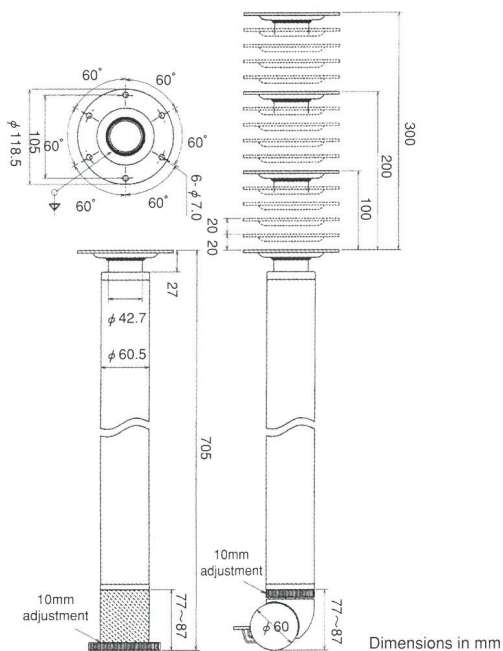

Interchangeable

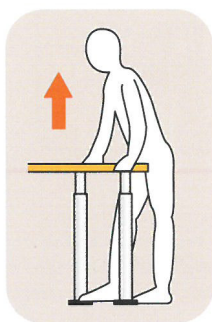
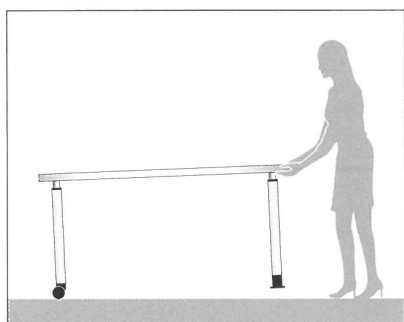
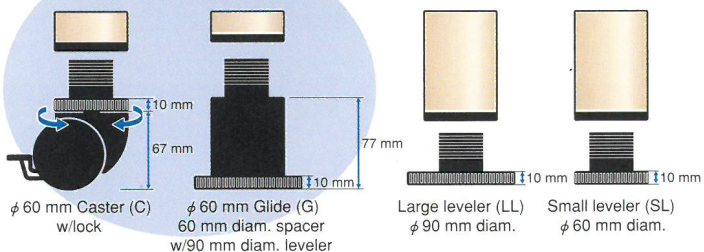

Package

External Dimensions
 645mm×345mm×145mm
 4PCS/13kg/1CTN
 2,500 legs per 20ft container
 5,000 legs per 40ft container
 Screws are not included
 Accessories are packed separately



LEGMAN KVI SERIES

Dimensional data not binding. We reserve the right to alter specifications without prior notice.

PEDESTAL LEG APPLICATION W / ANTI-ROTATION DEVICE



Product Name ADJUSTABLE LEG	Adjustable range(mm)	Steps	Per Step (mm)	Height range (mm) Min-Max
KVI 640W-1	100	5	20	640-740
KVI 640W-2	200	10	20	640-840
KVI 640W-3	200	5	40	640-840
KVI 640W-4	300	15	20	640-940

Diameter of leg available : 60.5 mm

Koyo will upon customer requests modify the base fitting of the Legman to fit customers requirements (minimum quantities apply).

Formula of Product Code

KVI 640W- 1

Minimum Height
(without base)

Type of Adjustable range/step
(See Backside)

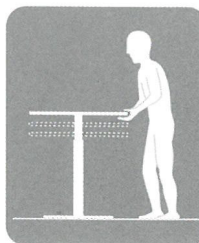
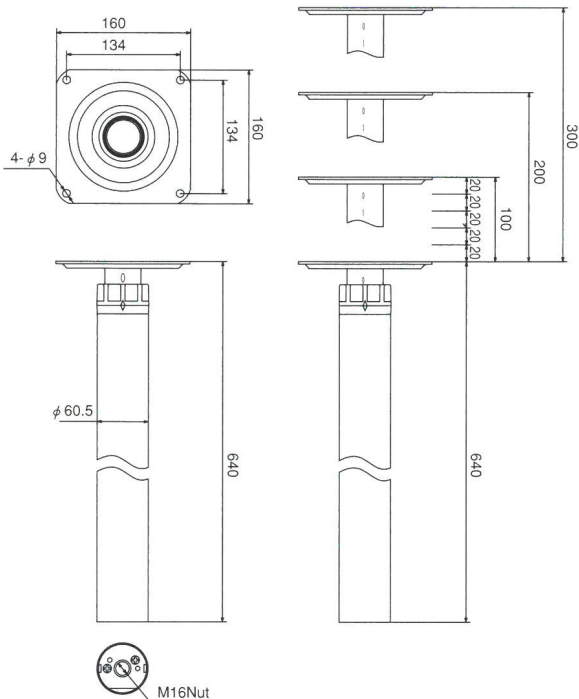

Lock Cap Mechanism

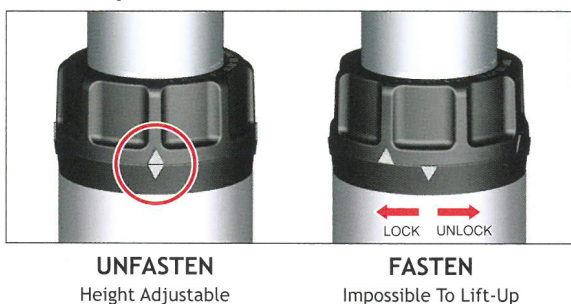

Package for Standard Square Mounting Plate

External Dimensions
680mm×290mm×180mm
2PCS/8kg/1CTN
1,140 legs per 20ft container
2,280 legs per 40ft container
Screws are not included



LEGMAN KVS SERIES

Dimensional data not binding. We reserve the right to alter specifications without prior notice.

SLIM MULTIPLE LEG APPLICATION



Product Name STATIC LEG	Adjustable range(mm)	Steps	Per Step (mm)	Height range (mm) Min-Max
KVS 705	0	0	0	705
Product Name ADJUSTABLE LEG	Adjustable range(mm)	Steps	Per Step (mm)	Height range (mm) Min-Max
KVS 705-1	100	5	20	705-805
KVS 705-2	200	10	20	705-905
KVS 705-3	200	5	40	705-905
KVS 705-4	300	15	20	705-1005

Diameter of leg available : 42.7mm

450kg loading capacity per leg.

Note: Do not twist inner tube and outer tube at the same time. It may damage its mechanism.

Formula of Product Code

KVS 705- 1

Minimum Height
(Included Caster / Leveler)

Type of Adjustable range/step
(See Backside)

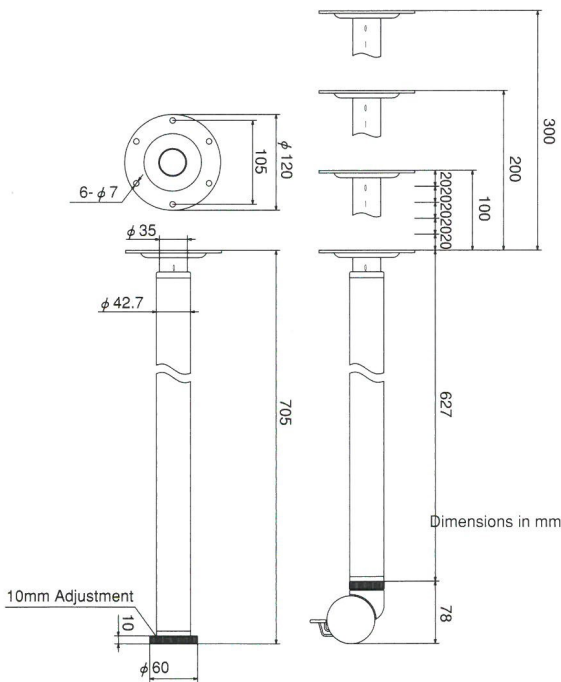

Note : Caster and leveler are interchangeable, but tube's length is different. See a diagram

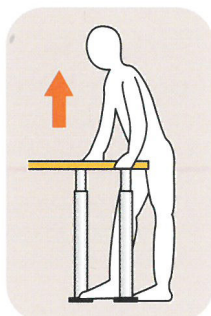

Package

External Dimensions
645mm×345mm×145mm
4PCS/8kg/1CTN
2,500 legs per 20ft container
5,000 legs per 40ft container
Screws are not included
Accessories are packed separately



LEGMAN KV-AL SERIES

Dimensional data not binding. We reserve the right to alter specifications without prior notice.

ALUMINUM LEG APPLICATION



Product Name ADJUSTABLE LEG	Adjustable range(mm)	Steps	Per Step (mm)	Height range (mm) Min-Max
KV 670AL-1	100	5	20	670-770
KV 670AL-2	200	10	20	670-870
KV 670AL-3	200	5	40	670-870
KV 670AL-4	300	15	20	670-970

Diameter of leg available : 60.5 mm
Note : Casters / Glides not included (order separately)

Formula of Product Code

KV 670 AL - 1

Minimum Height (Included Caster / Glide) | Aluminum | Type of Adjustable range/step (See Backside)

Leveler plus spacer equals the same height as casters (77-87mm)

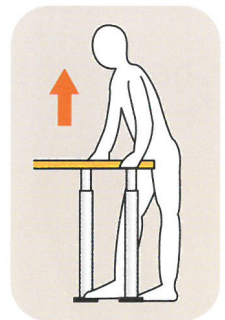
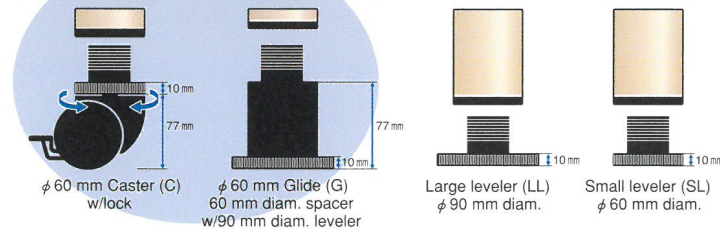

LEGMAN KVS-P SERIES

FOLDING with SLIM HEIGHT ADJUSTMENT

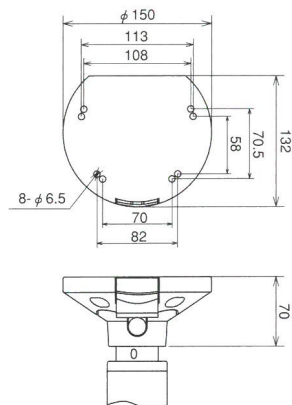

Product Name ADJUSTABLE LEG	Adjustable range(mm)	Steps	Per Step (mm)	Height range (mm) Min-Max
KVS 670P-1	100	5	20	670-770
KVS 670P-2	200	10	20	670-870
KVS 670P-3	200	5	40	670-870
KVS 670P-4	300	15	20	670-970

Diameter of leg available : 42.7 mm
450Kg loading capacity per leg.
Note : Do not twist inner tube and outer tube at the same time, it may damage its mechanism.

Foldable Leg

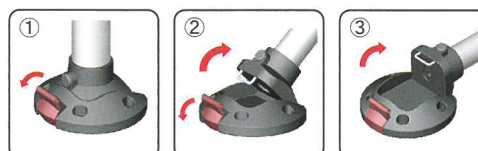
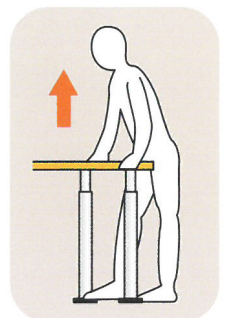
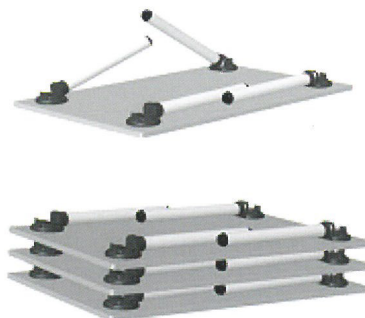

Note : Caster and leveler are interchangeable, but tube's length is different.

Spec.

	KV	KVI	KVS
Feature	Standard, Multiple leg applications	Pedestal table	Slim type for multiple leg applications
Mounting plate	φ120mm	φ160mm square	φ120mm
Diameter of leg	φ60mm	φ60mm	φ43mm
Length of leg(at the shortest point) <small>Available in special length when ordered in sufficient quantities</small>	705mm(Included Caster/Glide)	640mm	705mm(Included Caster/Glide)
Adjustment range	100mm 200mm 300mm	100mm 200mm 300mm	100mm 200mm 300mm
Color	Silver Black Chrome Woody	Silver Black Chrome	Silver Black Chrome
Accessory	Caster Glide	N / A	Caster Leveler
Load capacity	900kg (1,980 Lbs.) /a leg	900kg (1,980 Lbs.) /a leg	450kg (990 Lbs.) /a leg
Weight	3kg/pc	3.5kg/pc	1.76kg/pc
Packing info.	645×345×145 4pcs/a box 13kg/a box	680×290×180 2pcs/a box 8kg/a box	645×345×145 4pcs/a box 8kg/a box

Choice of Standard Colors / Finishes.

Please Note : Actual Color may be different from shown due to printing on paper.



Technical Note :

Each Stroke Length requires the following minimum dimension of leg :
 100 mm stroke length : 330 mm leg (without accessories)
 200 mm stroke length : 430 mm leg (without accessories)
 300 mm stroke length : 530 mm leg (without accessories)

Type of Adjustable range / step.

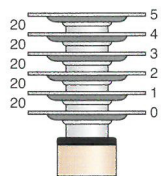

TYPE 1 : 100 mm range, 5 steps, 20 mm per step

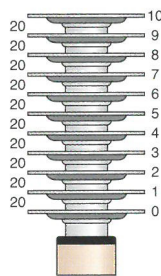

TYPE 2 : 200 mm range, 10 steps, 20 mm per step

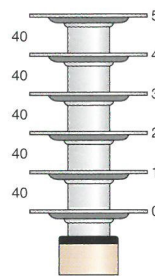

TYPE 3 : 200 mm range, 5 steps, 40 mm per step

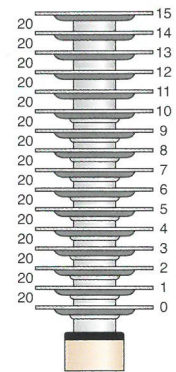

TYPE 4 : 300 mm range, 15 steps, 20 mm per step

KOYO LEGMAN WARRANTY

All items manufactured by KOYO are guaranteed against defective material for the period of 3 years from the date of purchase.

We will repair or replace without cost to our customers any defective item. In no event shall liability under this warranty exceed the purchase price of the product. We will not repair or replace at our cost any item which has been altered, subjected to misuse, negligence, accident, or used for any other purpose than that for which it was originally designed.

To make a claim under this warranty, contact KOYO for written return authorization. Returned merchandise without written authorization will not be credited. After inspection of returned item, if it is established by KOYO to be defective under terms of warranty, appropriate credit, replacement or repair will issued.

2009. 03



KOYO ENGINEERING CO., LTD.

1214 Kusabe, Sakai-city, Nishi-ku, Osaka, 593-8312 Japan
 Tel : +81-72-275-1300 Fax : +81-72-273-1777
 www.koyoeng.co.jp E-mail : info@koyoeng.co.jp

Contact to